

BELMONT COUNTY, OHIO  
 YORK TWP.  
 WASHINGTON TWP.

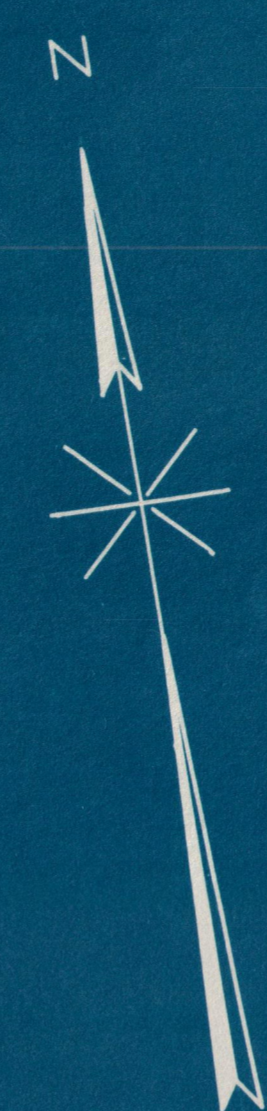

Correct as of Dec. 31st, 1955.	Revis	6
Correct as of Dec. 31st, 1954.	No Revision	
Correct as of Dec. 31st, 1953.	No Revision	
Correct as of Dec. 31st, 1952.	Map Revised	
Correct as of Dec. 31st, 1951.	No Revision	
Correct as of Dec. 31st, 1950.	No Revision	
Correct as of Dec. 31st, 1949.	No Revision	
Correct as of Dec. 31st, 1948.	Map Revised	
Correct as of Dec. 31st, 1947.	Map Revised	
Correct as of Dec. 31st, 1946.	Revis	
Correct as of Dec. 31st, 1945.	Revis	
Correct as of Dec. 31st, 1944.	Revis	
Correct as of Dec. 31st, 1943.	Revis	

*Pandrol Company*  
 RIGHT OF WAY AND TRACK MAP  
**PITTSBURGH, OHIO VALLEY AND CINCINNATI R.R.**  
 STATION 369+60 TO STATION 424+40  
 SCALE 1" = 100'      JUNE 30, 1918  
 OFFICE OF VALUATION ENGINEER  
 PHILADELPHIA, PA.

V 24  
 OHIO  
 15.8  
 V 12  
 OHIO  
 15.8





PARCEL NO.	GRANTOR	GRANTEE	KIND OF INSTRUMENT	DATE OF INSTRUMENT	RECORDED			CUSTODIAN'S RECORD			AREA	REMARKS
					BOOK	PAGE	DATE	R. E. A.'S No.	BOX	PKG		
1	Anna S. Ramsey	P.O.V.&C.R.R.	Fee Deed	Oct. 10, 1947	373	239	Dec. 9, 1947	48177	3054	14	6.182A	
2	Arnest W. Richmond	"	"	Oct. 25, 1947	370	637	Nov. 31, 1947	48083	3054	12	4.772A	
3	Earl Harlan, Guardian of Walter Harlan	"	"	Oct. 15, 1948	377	623	Oct. 25, 1948	48274	3074	10	5.63A	
4	Lucy A. Van Dyne, widow	"	"	Mar. 3, 1953	389	550	Mar. 6, 1953	51642	3132	3	5.177Ac	Excepting underlying coal. RR to maintain grade crossing at or near present lane.